

WA-210

Wall Mounted Amplifier with USB/FM and Bluetooth®

Item ref: 953.131UK, 953.136UK

User Manual

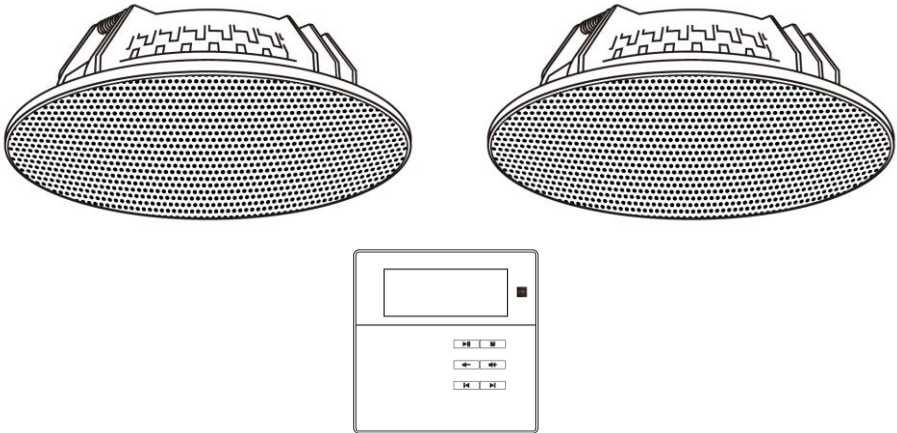

Version 1.0



Caution: Please read this manual carefully before operating
Damage caused by misuse is not covered by the warranty

Introduction

Thank you for choosing the Adastra WA-210 wall amplifier for your discreet audio installation. This unit is designed to provide a complete integrated solution for background music in rooms or corridors. Please read this manual to gain the best results from your product and avoid damage through misuse.

SAFETY SYMBOL AND MESSAGE CONVENTIONS



CAUTION
RISK OF ELECTRIC SHOCK
DO NOT OPEN

AVIS
RISQUE DE CHOC ELECTRIQUE NE PAS
OUVRIR



This symbol indicates that dangerous voltage constituting a risk of electric shock is present within this unit



This symbol indicates that there are important operating and maintenance instructions in the literature accompanying this unit.

Warning

To prevent the risk of fire or electric shock, do not expose any components to rain or moisture. If liquids enter the housing, disconnect the mains immediately, allow unit to dry out and have checked by qualified personnel before use. Avoid impact, extreme pressure or heavy vibration to the panel

No user serviceable parts inside

Do not open the case except for removing the front panel for installation

Refer all servicing to qualified service personnel.

Safety

- This product is powered directly from the mains supply and should only be fitted by a qualified electrical installer.

Placement

- The WA-210 can be installed into a partition wall using a standard 38mm deep pattress box
- The WA-210 can be surface mounted if necessary with a suitable back box
- Ensure adequate ventilation for cooling and keep away from combustible material or moisture
- Ensure that the WA-210 is within connection range of the sending device if using Bluetooth
- Do not set the panel fully into the wall and ensure adequate access to the bottom edge functions.

Cleaning

- Use a soft cloth with a neutral detergent to clean the panel as required
- Do not use solvents for cleaning the unit

Loudspeaker Installation

The WA-210 wall amplifier is available separately or as a WA-210-SET.

If supplied as a WA-210-SET, there are 2 ceiling speakers supplied.

The speakers may be installed into a plasterboard or tiled ceiling with at least 70mm to accommodate the mounting depth of each speaker.

The speakers should be wired to the WA-210 amplifier using standard twin speaker cable. 10m of suitable cable is supplied with the WA-210-SET and should be cut as required.

Carefully mark out and cut a hole 165-170mm diameter for each speaker.

Feed the speaker wires from each hole to the WA-210 (passing through the back box)

Connect the + and - wires to the + and - spring terminals and offer the speaker to the hole in the ceiling with the spring clamps either side on the magnet pressed fully up to fit through the hole fully extended and these will fold back down to hold the speaker in place (see opposite)

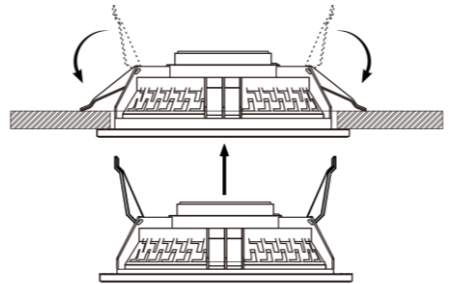

If the WA-210 is supplied without speakers, ensure that the load to be connected to each speaker output has no lower than 8Ω impedance and has a power handling of 10W max. Do not connect further speakers as this can cause damage to the WA-210 amplifier circuitry.

WA-210 Installation

The WA-210 amplifier can fit into a standard back box of 38mm depth or more (supplied). Adequate space for connections and ventilation should be ensured and a deeper back box may be beneficial.

Remove the front fascia of the WA-210 by carefully prizing it away from the main housing. A slot is visible on the right-hand side of the fascia which can be used to insert a screwdriver for this purpose.

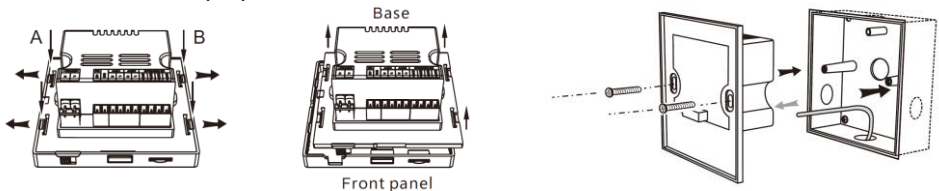

Removing the front fascia will reveal the mounting screw holes behind. These should be lined up with the threaded tabs inside the back box or used with screws that are suitable for the material if mounted directly into the wall.

Connection

Make all relevant connections at the rear of the WA-210 as described in the following section before mounting it inside the wall or back box.

Fit the WA-210 into the wall or back box using the 2 screws and press on the fascia until it clicks in place, ensuring that the lower edge inputs and power switch remain accessible.

Rear Panel

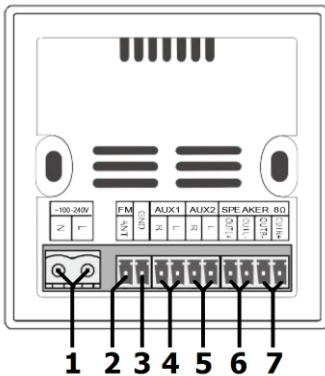

- 1 Mains terminals (100-240Vac, 50/60Hz)
- 2 FM aerial terminal (connect shield to GND)
- 3 GND common GROUND (antenna & line in)
- 4 AUX 1 L+R terminals (connect shield to GND)
- 5 AUX 2 L+R terminals (connect shield to GND)
- 6 Left speaker terminals (+ and -)
- 7 Right speaker terminals (+ and -)

Connections to the WA-210 are all made using the Euroblock screw terminals at the rear. These terminals may be unplugged for convenience when inserting the wiring to them. Ensure all speaker, FM aerial, AUX input and isolated mains wiring is already fed through the wall and through the back box ready for connection to the WA-210 rear panel.

Connect left and right speaker wires to the relevant "+/-" terminals on the WA-210 (6, 7) For better FM reception, an aerial may be connected to the FM and GND terminals (2, 3)

Line level inputs from external audio sources may be connected to the AUX terminals. These should be connected to the relevant sources and fed back to the WA-210 using shielded 2-core cable.

Connect Left+ and Right+ to the AUX 1 terminals (4) and both Left- and Right- to GND (3) Similarly, for AUX 2, connect L+/R+ to the AUX 2 terminals (5) and L-/R- both to GND (3) Finally, with the mains isolated, connect Live and Neutral to the mains terminals (1)

Plug in all Euroblock terminals before installing the WA-210 into the wall or back box. Feed the wiring carefully into the wall cavity to take up any excess, rather than compressing it inside the back box, which may damage the wire and connections.

Keep the mains power isolated (off) until the WA-210 is fully installed into the wall, covering the rear panel wiring.

Front Panel

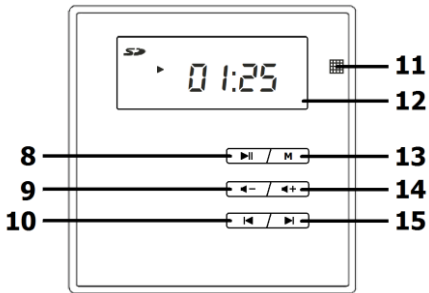

- 8 Play/Pause or FM auto-tune
- 9 Decrease volume
- 10 Previous track/FM station
- 11 I.R. remote receiver
- 12 Backlit LCD display
- 13 M key - Mode select
- 14 Increase volume
- 15 Next track/FM station

Bottom Edge

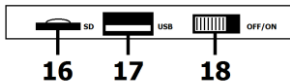

- 16 MicroSD card slot
- 17 USB port
- 18 On/Off slide switch

Operation

To power up the WA-210, slide the On/Off switch on the underside to the "ON" position (18). The LCD screen will light up and show the status (12).

Control is available from the front panel or via the supplied I.R. remote control handset. Remove the plastic tab to enable the CR2025 battery on first use.

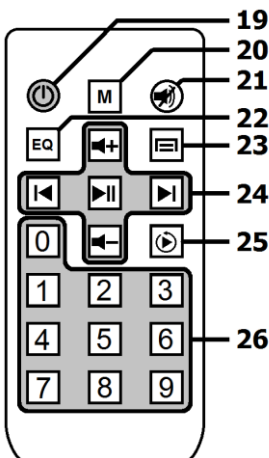

- 19 Power on/off
- 20 M key - Mode select
- 21 Mute on/off
- 22 EQ mode select
- 23 [not used]
- 24 Previous, Play/Pause, Next, Volume +, Volume -
- 25 Repeat key
- 26 Numerical keypad - track/frequency select

USB/SD Player

Insert media or press the M key until the USB or SD symbol is shown in the display.

If there is no USB or microSD media connected (17), the display will flash "NO".

If a connected USB/SD device has content which cannot be read, the display will show "----"

If the USB or SD device has files with suitable format, playback will begin automatically.

Press Play/Pause to pause or continue playback

Use Previous and Next to step through tracks.

Press and hold Previous or Next for fast reverse or fast forward search.

Press "Volume +" to increase volume or "Volume -" to decrease volume.

Some additional functions are available for playback on the remote control.

The WA-210 can be powered down or powered on remotely using the Power on/off key

The mode is selected by pressing the M key followed by a number 1 to 6.

(1 = SD, 2 = AUX1, 3 = AUX2, 4 = Bluetooth, 5 = FM, 6 = USB)

Direct track selection can be made by entering the track number on the numerical keypad.

Pressing the Repeat key will toggle between repeat ONE or repeat ALL tracks.

During playback, pressing the EQ button steps through Pop, Rock, Jazz or Normal presets

Press MUTE to mute the output during playback. Press MUTE again to resume output.

FM Tuner

Press the M button until the display shows "FM" and a frequency in MHz

To initiate auto-tune to find available stations, press and hold the Play/Pause key.

After auto-tuning, pressing Previous and Next keys will step through stored channels.

A short press on the Play/Pause key will mute or un-mute the FM tuner output

Press and hold Previous or Next to enter manual tuning and use short presses to fine tune.

Press "Volume +" to increase volume or "Volume -" to decrease volume.

Some additional functions are available for playback on the remote control.

The WA-210 can be powered down or powered on remotely using the Power on/off key

The mode is selected by pressing the M key followed by a number 1 to 6.

(1 = SD, 2 = AUX1, 3 = AUX2, 4 = Bluetooth, 5 = FM, 6 = USB)

Direct frequency selection can be made by entering the frequency on the numerical keypad.

(enter to 1 decimal place – i.e. "0985" will tune to 98.5MHz)

During playback, pressing the EQ button steps through Pop, Rock, Jazz or Normal presets

Press MUTE to mute the output during playback. Press MUTE again to resume output.

Auxiliary Inputs

Press M until the display shows AUX1 or AUX2 to enable stereo line audio from these inputs.

Press "Volume +" to increase volume or "Volume -" to decrease volume.

Pressing Play/Pause (or Mute on the remote) will mute or un-mute the output.

Pressing the EQ button on the remote steps through Pop, Rock, Jazz or Normal presets.

Bluetooth Mode

The WA-210 may be paired to a smart phone or tablet via Bluetooth for wireless playback.

Enable Bluetooth on the sending device and search for the device ID "DABA".

Select to pair with "DABA" and the Bluetooth symbol will stop flashing on the display.

An audible alert will confirm the pairing.

Play audio tracks on the sending device and check for output on the connected speakers.

Ensure that the volume level on the sending device is not set too low or at zero.

Press Play/Pause to pause or continue playback.

Previous and Next keys on the WA-210 will remotely select tracks on the sending device.

Press "Volume +" to increase volume or "Volume -" to decrease volume.

Pressing Mute on the remote will mute or un-mute the output.

Pressing the EQ button on the remote steps through Pop, Rock, Jazz or Normal presets.

Powering down

For temporary standby, the WA-210 media player can be switched off via the remote or by holding the M button on the WA-210 panel

To fully switch power off to the WA-210, slide the Power on/off switch on the bottom edge to the Off position.

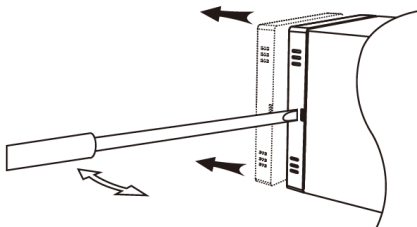

If it is necessary at any time to remove the front panel, insert a screwdriver into the slot at the side and carefully pry open the clips and pull the front fascia forwards.

To replace the front panel, align the multi-pin connector with the internal socket and push into place until the edges click secure.

Specifications: WA-210

Power supply	100-240Vac, 50/60Hz (screw terminal)
Mounting depth	28mm (38mm recommended)
Output power: 8 Ohms	2 x 10W (max)
THD	<0.03% @1kHz 1W
SNR	>81dB
Frequency response	20Hz - 20kHz
Audio format	mp3, wma, wav, flac
Bluetooth version	2.1 + EDR
Remote : battery	CR2032
Dimensions	86 x 86 x 37mm
Weight	128g

Specifications: Ceiling Speakers (WA-210-SET)

Driver	165mmØ (6.5") dual reinforced paper cone
Cutout	165-170mmØ
Mounting depth	65mm
Frequency response	110Hz – 15kHz
Power handling RMS	5W
Power handling Max	10W
Impedance	8Ω
Max SPL	97±2dB
Sensitivity @ 1W/1m	90±2dB
Dimensions	70 x 190mmØ
Weight	520g



Disposal: The "Crossed Wheelie Bin" symbol on the product means that the product is classed as Electrical or Electronic equipment and should not be disposed with other household or commercial waste at the end of its useful life. The goods must be disposed of according to your local council guidelines.